

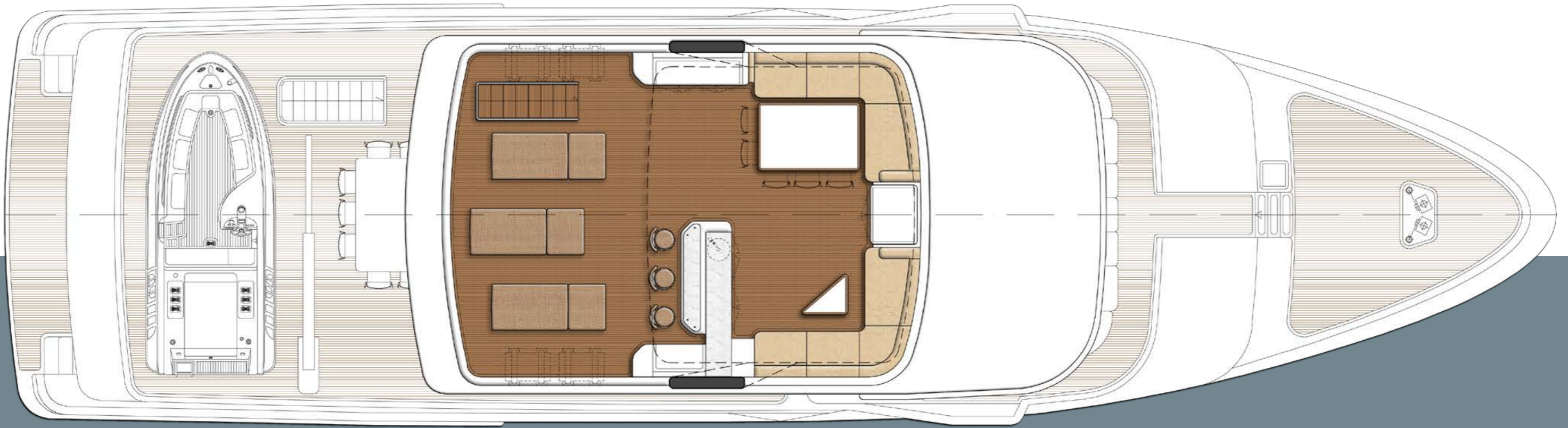

THUNDERBIRD EXPLORER 90'





THUNDERBIRD EXPLORER 90

SHORT TECHNICAL SPECIFICATION

STYLING & INTERIOR DESIGN	Borzelli & Berta Architetti
NAVAL ARCHITECTURE & ENGINEERING	NAMES by Francesco Rogantin
THE BUIDER	GHI Yachts
Length, over all	27.41 m
Length, water line	25.20 m
Beam, max	7.30 m
Draft, full load ab. B.L.	2.20 m
Displacement, full load	230 t
Hull shape	Full displacement
Class society	KR/ABS/LR
Flag	MCA, LY3
Fuel oil	32,000 lt
Fresh water	7,000 lt
Black/Grey water	2,500 lt
Speed, maximum	11.5 kn
Speed, cruise	10.0 kn
Range at 9 kn	>3500 nm
Main engine	n. 2 x Caterpillar C18, 715 hp @ 2,100 rpm
Gearbox	n. 2 x ZF+PTO
Watermaker	n. 2 x 1,500 GPD
Bow thruster	Hydraulic, max power 60 hp ca.
Propeller shaft	Aisi 316
Propeller	2 X FPP, 4 Blades, NI-BR-AL or equivalent
Steering system	Kobelt Electro-hydraulic steering, Follow-Up type
Capstans	n. 2 x Muir or Maxwell
Mooring winches	n. 2 x Muir or Maxwell
Anchors	n. 2 x HHP hot dip galvanized steel
Tender davit	Telescopic electro hydraulic davit, 1,200 kg load

[All our short specifications are with reservation of in between changes](#)

THUNDERBIRD EXPLORER 90'



MAIN DECK



LOWER DECK



SUN DECK



UPPER DECK